

PEIAN ELECTRONIC MANUFACTURING CO LTD

1 Feature

- 1) EMI/EMC SMD power inductor.
- 2) High-quality factor.
- 3) Big current and inductance .
- 4) Special design for welding .



2 Application

Adjustor , power ,

3 Material

Iron core

Enamelled Wire

4. Dimension (:mm)

(1)

PA43~PA105

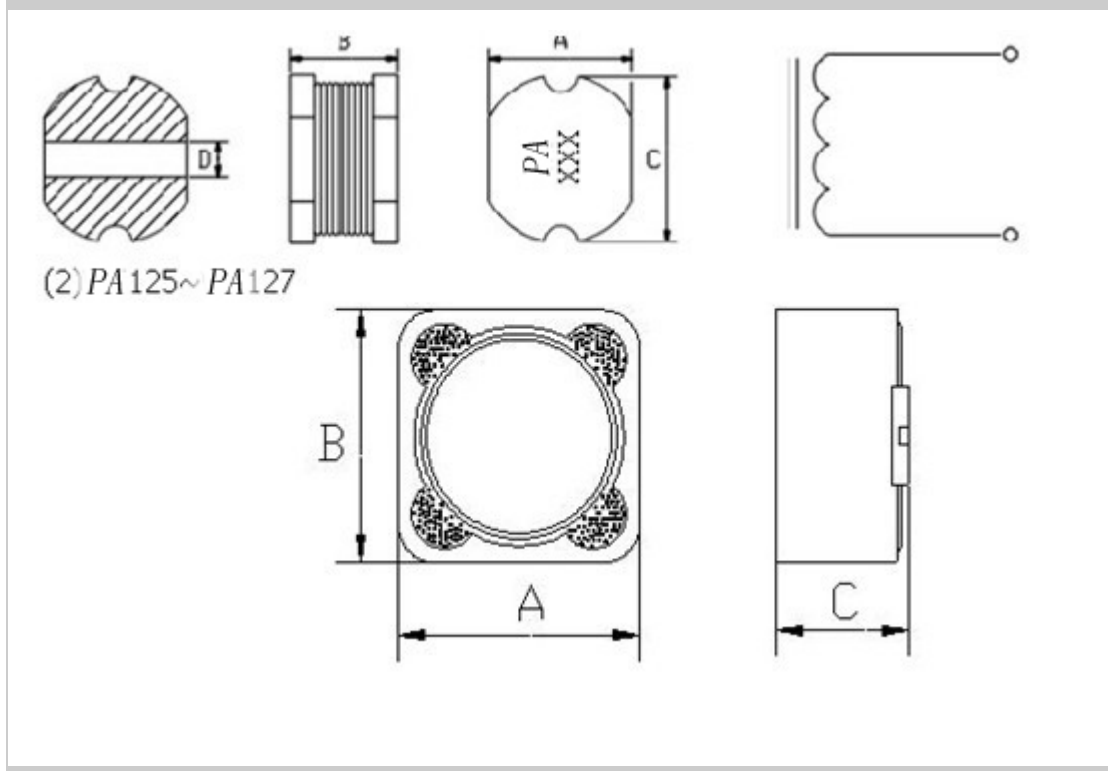

SPECIFICATION

TYPE	A	B	C	D
PA43	4.4MAX	3.8MAX	4.7MAX	1.0 REF
PA54	5.5 MAX	5.0MAX	6.1 MAX	1.3 REF
PA75	7.2 MAX	5.6 MAX	7.9 MAX	2.1 REF
PA104	9.5 MAX	4.5 MAX	10.2 MAX	2.1 REF
PA105	9.5 MAX	6.4 MAX	10.4 MAX	2.9 REF
PA125	12.5+0.3	12.5+0.3	5.8+0.3	
PA127	12.5+0.3	12.5+0.3	7.6+0.3	

Specification Instrucation

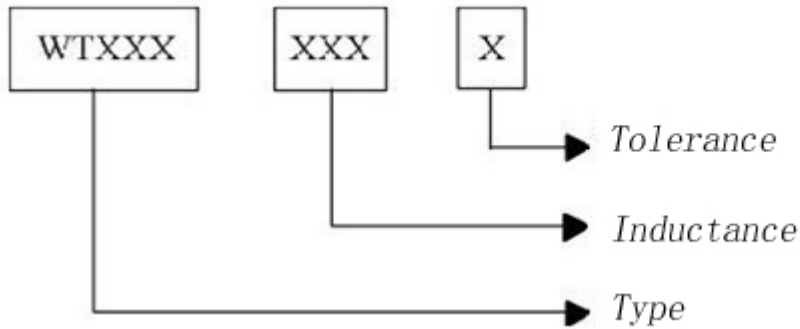

TYPE

(1) PA43

NO.	PART NO.	INDUCTANCE (Ω H)	TEST FREQUENCY	DC RESISTANCE (Ω) MAX	IDC (A) MAX	REMARK
1	PA43-1R0M	1. 00 _{+20%}	7. 96MHz	26. 0m	2. 52	
2	PA43-1R4M	1. 40 _{+20%}	7. 96MHz	31. 4m	2. 52	
3	PA43-1R8M	1. 80 _{+20%}	7. 96MHz	38. 4m	1. 95	
4	PA43-2R2M	2. 20 _{+20%}	7. 96MHz	46. 4m	1. 58	
5	PA43-2R7M	⁺ 2. 70 _{+20%}	7. 96MHz	57. 1m	1. 58	
6	PA43-3R3M	3. 30 _{+20%}	7. 96MHz	73. 1m	1. 20	
7	PA43-3R9M	3. 90 _{+20%}	7. 96MHz	7. 90m	1. 20	
8	PA43-4R7M	4. 70 _{+20%}	7. 96MHz	84. 7m	1. 20	
9	PA43-5R6M	5. 60 _{+20%}	7. 96MHz	106. 7m	1. 00	
10	PA43-6R8M	6. 80 _{+20%}	7. 96MHz	122. 8m	1. 00	
11	PA43-8R2M	8. 20 _{+20%}	7. 96MHz	154. 8m	0. 95	
12	PA43-100K	10. 0 _{+10%}	2. 52MHz	0. 159	0. 95	
13	PA43-120K	12. 0 _{+10%}	2. 52MHz	0. 183	0. 90	
14	PA43-150K	15. 0 _{+10%}	2. 52MHz	0. 235	0. 85	
15	PA43-180K	18. 0 _{+10%}	2. 52MHz	0. 272	⁺ 0. 74	
16	PA43-220K	22. 0 _{+10%}	2. 52MHz	0. 334	0. 68	
17	PA43-270K	27. 0 _{+10%}	2. 52MHz	0. 391	0. 62	

18	PA43-330K	33.0 \pm 10%	2.52MHz	0.459	0.56	
19	PA43-390K	39.0 \pm 10%	2.52MHz	0.558	0.52	
20	PA43-470K	47.0 \pm 10%	2.52MHz	0.577	0.44	
21	PA43-560K	56.0 \pm 10%	2.52MHz	0.705	0.42	
22	PA43-680K+	68.0 \pm 10%	2.52MHz	0.979	0.37	

Testing equipment : 1. HP4286 A2. CH502AC

(2) PA54 TYPE

NO.	PART NO.	INDUCTANCE (Ω H)	TEST FREQUENCY	DC RESISTANCE (Ω)MAX	IDC(A) MAX	REMARK
1	PA54-100M	10.0 \pm 20%	2.52MHz	0.10	1.44	
2	PA54-120M	12.0 \pm 20%	2.52MHz	0.11	1.40	
3	PA54-150M	15.0 \pm 20%	2.52MHz	0.12	1.30	
4	PA54-180M	18.0 \pm 20%	2.52MHz	0.15	1.23	
5	PA54-220M	22.0 \pm 20%	2.52MHz	0.18	1.11	
6	PA54-270M	27.0 \pm 20%	2.52MHz	0.21	0.97	
7	PA54-330L	33.0 \pm 15%	2.52MHz	0.24	0.88	
8	PA54-390L	39.0 \pm 15%	2.52MHz	0.32	0.80	
9	PA4-470L	47.0 \pm 15%	2.52MHz	0.36	0.72	
10	PA54-560K	56.0 \pm 10%	2.52MHz	0.39		
NO.	PART NO.	INDUCTANCE (Ω H)	TEST FREQUENCY	DC RESISTANCE (Ω)MAX	IDC(A) MAX	REMARK
1	PA75-100K	10.0 \pm 10%	2.52MHz	0.06	2.30	
2	PA75-120K	12.0 \pm 10%	2.52MHz	0.07	2.00	
3	PA75-150K	15.0 \pm 10%	2.52MHz	0.09	1.80	
4	PA75-180K	18.0 \pm 10%	2.52MHz	0.1	1.60	
5	PA75-220K	22.0 \pm 10%	2.52MHz	0.11	1.50	
6	PA75-270K	27.0 \pm 10%	2.52MHz	0.12	1.30	
7	PA75-330K	33.0 \pm 10%	2.52MHz	0.15	1.20	
8	PA75-390K	39.0 \pm 10%	2.52MHz	0.16	1.10	
9	PA75-470K	47.0 \pm 10%	2.52MHz	0.18	1.10	

10	PA75-560K	56.0 \pm 10%	2.52MHz	0.21	0.94	
11	PA75-680K	68.0 \pm 10%	2.52MHz	0.26	0.85	
12	PA75-820K	82.0 \pm 10%	2.52MHz	0.32	0.78	
13	PA75-101K	100 \pm 10%	1.00KHz	0.37	0.72	
14	PA75-121K	120 \pm 10%	1.00KHz	0.44	0.66	
15	PA75-151K	150 \pm 10%	1.00KHz	0.53	0.58	
16	PA75-181K	180 \pm 10%	1.00KHz	0.64	0.51	
17	PA75-221K	220 \pm 10%	1.00KHz	0.74	0.49	
18	PA75-271K	270 \pm 10%	1.00KHz	1.00	0.42	
19	PA75-331K	330 \pm 10%	1.00KHz	1.23	0.40	
20	PA75-391K	390 \pm 10%	1.00KHz	1.42	0.36	
21	PA75-471K	470 \pm 10%	1.00KHz	1.64	0.34	

TESTING EQUIPMNET: 1. HP4286 A2. HP4284 A3. CH502AC

(4) PA104 TYPE

NO.	PART NO.	INDUCTANCE (Ω H)	TEST FREQUENCY	DC RESISTANCE (Ω) MAX	IDC (A) MAX	REMARK
1	PA104-100M	10.0 \pm 20%	2.52MHz	0.06	2.38	
2	PA104-120M	12.0 \pm 20%	2.52MHz	0.07	2.13	
3	PA104-150M	15.0 \pm 20%	2.52MHz	0.09	1.87	
4	PA104-180M	18.0 \pm 20%	2.52MHz	0.11	1.73	
5	PA104-220M	22.0 \pm 20%	2.52MHz	0.12	1.60	
6	PA104-270M	27.0 \pm 20%	2.52MHz	0.14	1.44	
7	PA104-330M	33.0 \pm 20%	2.52MHz	0.16	1.26	
8	PA104-390M	39.0 \pm 20%	2.52MHz	0.18	1.20	
9	PA104-470M	47.0 \pm 20%	2.52MHz	0.21	1.10	
10	PA104-560K	56.0 \pm 10%	2.52MHz	0.275	1.01	
11	PA104-680K	68.0 \pm 10%	2.52MHz	0.29	0.91	
12	PA104-820K	82.0 \pm 10%	2.52MHz	0.32	0.85	
13	PA104-101K	100 \pm 10%	1.00KHz	0.39	0.74	
14	PA104-121K	120 \pm 10%	1.00KHz	0.40	0.69	

15	PA104-151K	150 \pm 10%	1.00KHz	0.58	0.61	
16	PA104-181K	180 \pm 10%	1.00KHz	0.72	0.56	
17	PA104-221K	220 \pm 10%	1.00KHz	0.81	0.53	
18	PA104-271K	270 \pm 10%	1.00KHz	0.98	0.45	
19	PA104-331K	330 \pm 10%	1.00KHz	1.25	0.42	
20	PA104-391K	390 \pm 10%	1.00KHz	1.59	0.38	
21	PA104-471K	470 \pm 10%	1.00KHz	1.75	0.35	
22	PA104-561K	560 \pm 10%	1.00KHz	1.97	0.32	

TESTING EQUIPMENT: 1. HP4286 A 2. HP4284 A 3. CH502AC

(5) PA105 TYPE

NO.	PART NO.	INDUCTANCE (Ω H)	TEST FREQUENCY	DC RESISTANCE (Ω)MAX	IDC (A) MAX	REMARK
1	PA105-100M	10.0 \pm 20%	2.52MHz	0.05	2.60	
2	PA105-120M	12.0 \pm 20%	2.52MHz	0.06	2.45	
3	PA105-150M		2.52MHz	0.17	1.28	
10	PA105-560K	56.0 \pm 10%	2.52MHz	0.19	1.17	
11	PA105-680K	68.0 \pm 10%	2.52MHz	0.21	1.11	
12	PA105-820K	82.0 \pm 10%	2.52MHz	0.26	1.00	
13	PA105-101K	100 \pm 10%	1.00KHz	0.28	0.97	
14	PA105-121K	120 \pm 10%	1.00KHz	0.35	0.89	
15	PA105-151K	150 \pm 10%	1.00KHz	0.43	0.78	
16	PA105-181K	180 \pm 10%	1.00KHz	0.50	0.72	
17	PA105-221K	220 \pm 10%	1.00KHz	0.61	0.66	
18	PA105-271K	270 \pm 10%	1.00KHz	0.75	0.57	
19	PA105-331K	330 \pm 10%	1.00KHz	0.84	0.52	
20	PA105-391K	390 \pm 10%	1.00KHz	1.04	0.48	
21	PA105-471K	470 \pm 10%	1.00KHz	1.18	0.42	
22	PA105-561K	560 \pm 10%	1.00KHz	1.51	0.33	
23	PA105-681K	680 \pm 10%	1.00KHz	1.72	0.28	
24	PA105-821K	820 \pm 10%	1.00KHz	2.24	0.24	

TESTING : 1. HP4286 A 2. HP4284 A 3. CH502AC

(6) PA125 TYPE

NO.	PART NO.	INDUCTANCE (Ω H)	TEST FREQUENCY	DC RESISTANCE (Ω) MAX	IDC (A) MAX	REMARK+
1	PA125-100M	10. 0 \pm 20%	2. 52MHz	0. 080	2. 38	
2	PA125-150M	15. 0 \pm 20%	2. 52MHz	0. 090	1. 87	
3	PA125-220M	22. 0 \pm 20%	2. 52MHz	0. 110	1. 60	
4	PA125-330M	33. 0 \pm 20%	2. 52MHz	0. 140	1. 26	
5	PA125-470M	47. 0 \pm 20%	2. 52MHz	0. 200	1. 10	
6	PA125-680M	68. 0 \pm 10%	2. 52MHz	0. 240	0. 91	
7	PA125-101M	100 \pm 10%	1. 00MHz	0. 420	0. 74	
8	PA125-121M	120 \pm 10%	1. 00MHz	0. 460	0. 69	
9	PA125-151M	150 \pm 10%	1. 00MHz	0. 620	0. 61	
10	PA125-221K	220 \pm 10%	1. 00MHz	0. 750	0. 53	
11	PA125-271K	270 \pm 10%	1. 00MHz	0. 860	0. 45	

TESTING EQUIPMENT: 1. HP4286 A 2. HP4284 A 3. CH502AC

(7) PA127 TYPE

O.	PART NO.	INDUCTANCE (Ω H)	TEST FREQUENCY	DC RESISTANCE (Ω) MAX	IDC (A) MAX	REMARK
1	PA127-100M	10. 0 \pm 20%	2. 52MHz	0. 07	2. 60	
2	PA127-120M	12. 0 \pm 20%	2. 52MHz	0. 07	2. 45	
3	PA127-150M	15. 0 \pm 20%	2. 52MHz	0. 08	2. 27	
4	PA127-180M	18. 0 \pm 20%	2. 52MHz	0. 10	2. 15	
5	PA127-220M	22. 0 \pm 20%	2. 52MHz	0. 11	1. 95	
6	PA127-270M	27. 0 \pm 20%	2. 52MHz	0. 14	1. 76	
7	PA127-330M	33. 0 \pm 20%	2. 52MHz	0. 15	1. 50	
8	PA127-390M	39. 0 \pm 20%	2. 52MHz	0. 16	1. 37	
9	PA127-470M	47. 0 \pm 20%	2. 52MHz	0. 16	1. 28	
10	PA127-560K	56. 0 \pm 10%	2. 52MHz	0. 18	1. 17	
11	PA127-680K	68. 0 \pm 10%	2. 52MHz	0. 19	1. 11	

12	PA127-820K	82.0 \pm 10%	2.52MHz	0.23	1.00	
13	PA127-101K	100 \pm 10%	1.00KHz	0.28	0.97	
14	PA127-121K	120 \pm 10%	1.00KHz	0.30	0.89	
15	PA127-151K	150 \pm 10%	1.00KHz	0.36	0.78	
16	PA127-181K	180 \pm 10%	1.00KHz	0.40	0.72	
17	PA127-221K	220 \pm 10%	1.00KHz	0.44	0.66	
18	PA127-271K	270 \pm 10%	1.00KHz	0.50	0.57	
19	PA127-331K	330 \pm 10%	1.00KHz	0.70	0.52	
20	PA127-391K	390 \pm 10%	1.00KHz	0.90	0.48	
21	PA127-471K	470 \pm 10%	1.00KHz	1.20	0.42	
22	PA127-561K	560 \pm 10%	1.00KHz	1.30	0.33	
23	PA127-681K	680 \pm 10%	1.00KHz	1.50	0.28	
24	PA127-821K	820 \pm 10%	1.00KHz	1.80	0.24	

TYPE	A	B	C2	C1	N	T
12m/m	330	21 \pm 1	13 \pm 0.5	18	100	18.0
16m/m	330	21 \pm 1	13 \pm 0.5	18	100	23.5
24m/m	330	21 \pm 1	13 \pm 0.5	18	100	31.5
32m/m	330	21 \pm 1	13 \pm 0.5	18	100	38.0

*PA43; 12m/m1500pcs/REEL 1000pcs/REEL;

*PA54; 12m/m1500pcs/REEL 500pcs/REEL

*PA104, 24m/m

*PA105, 24m/m;

*PA751000pcs/REEL 500pcs/REEL

&, amp;, amp;,,

nbsp;*PA125

*PA12732m/m 300pcs/REEL